

Office Space in Los Lunas

2700 Palmilla Road | Los Lunas, NM

FOR LEASE

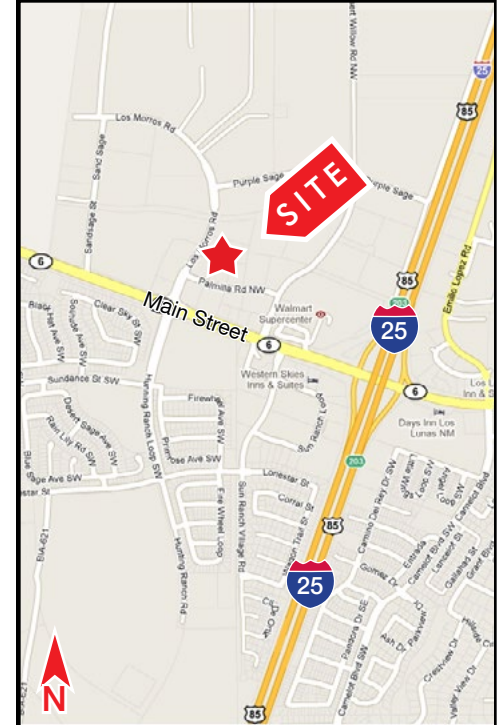

PROPERTY DETAILS

ADDRESS 2700 Palmilla Rd
Los Lunas, NM

LEASE RATE \$13.50/SF + NNN

BUILDING ±9,000 SF

AVAILABLE ±1,762 - 3,523 RSF

BENEFITS

- Separate entrance
- On “Growth” side of town
- Building signage available
- Access to building’s conference room, & break room
- Abundance of parking (over 4:1,000)
- New building space in shell condition
- Landlord will build out to meet tenant’s needs

For more information please contact:

DAVE HILL, CCIM
dave@gotSPACEUSA.com

SHELLY BRANSCOM
shelly@gotSPACEUSA.com

www.gotSPACEUSA.com

6801 Jefferson NE, Suite 200
Albuquerque, NM 87109

505.878.0001

The information contained is believed reliable. While we do not doubt the accuracy, we have not verified it and make no guarantee, warranty or representation about it. It is your responsibility to independently confirm its accuracy and completeness. Any projection, opinion, assumption or estimated uses are for example only and do not represent the current or future performance of the property. The value of this transaction to you depends on many factors which should be evaluated by your tax, financial, and legal counsel. You and your counsel should conduct a careful independent investigation of the property to determine that it is suitable to your needs.

NAI Maestas & Ward

